

## LR-500 Programmable Display Receiver

**Model:** LR-500-072 (for 72MHz)  
LR-500-216 (for 216MHz)

**Specify Part Number**  
LR-500-072  
or LR-500-216

The Listen LR-500 Programmable Display Receiver offers 57 channels and is 100% digitally tuned. Listen's Look&Listen™ Display allows quick and easy verification of channel selection, programming status, RF signal strength, battery level and locking status. UP, DOWN, and SEEK buttons are available through the door for easy access, and programmability allows you to lock out unused channels to limit the number of channels your users have to seek through. A lockable door, multi-function LED, and built in belt clip make the LR-500 extremely versatile in any venue.



Lit LED = 'power on'  
Flashing = 'battery low'  
2X Flashing = 'charging'

Earphone plugs in here and can be securely fastened (accepts mono or stereo jacks)

Denotes 72 or 216MHz receiver

Select channel using up and down buttons; verify selection on the LCD

Mechanical lock prevents users for accessing batteries or SQ disabling controls



ON/OFF and volume control

Look & Listen™ Display – at-a-glance verification of channel selection, battery level, and RF signal strength

To find a channel depress "seek", or to lock the channel, hold button down for 5 seconds (prevents users from changing channels)

### Key Features

- Exceptional audio quality! 80dB sound-to-noise ratio!\* (\*ListenSQ™ must be enabled end-to-end on the system).
- 57 field tunable channels (unless you lock it on only one channel or program particular channels).
- Programmability allows you to limit channels so your users don't have to scan through unused channels.
- Is ideal for use with multiple audio sources, where the channel can be changed easily in the field.
- Look&Listen™ Display shows channel selection, programming mode, RF signal strength, locking status and battery indicator.
- Provides exterior access to SEEK and channel selection capabilities, thus, it's ideal for users who need to conveniently change channels or easily SEEK to find a channel with a transmission.
- Offers maximum flexibility – ideal for personal use, schools, language interpretation, museums, and high interference applications
- 100 % Digital – Listen receivers are digitally-tuned so transmission won't drift; assurance that when you select a channel, it stays on channel!
- Built in SmartCharge™ won't allow batteries to overcharge! Charging circuitry is conveniently built into Listen's receivers; never worry about unplugging a transformer at a certain time.
- Press SEEK to find an in-range transmitting channel; perfect for personal use.
- Mechanical locking door to prevent tampering.

Listen and the Listen logo are registered trademarks of Listen Technologies Corporation, copyright 2002.

# LR-500 Programmable Display Receiver

Side View of LR-500 Programmable Display Receiver

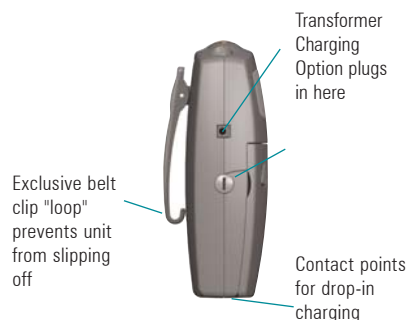

LR-500 Programmable Display Receiver with Lockable Door Open

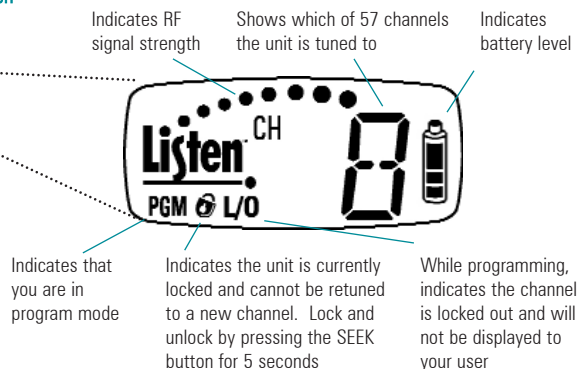

## Use With

LA-161 Single Ear Bud  
 LA-162 Dual Ear Buds  
 LA-164 Ear Speaker  
 LA-165 Stereo Headset  
 LA-166 Neckloop  
 LA-361 High Capacity Alkaline Batteries  
 LA-362 NiMH Rechargeable Batteries  
 LA-275 Sacrificial Cable

## Accessories

LA-319 Protective Pouch  
 LA-306 Soft Case  
 LA-202 Power/Charging Supply for Listen Portable Units  
 LA-317 4-Unit Charging/Carrying Case  
 LA-318 4-Unit Carrying Case  
 LA-323 8-Unit Charging/Carrying Case  
 LA-322 8-Unit Carrying Case  
 LA-311 16-Unit Charging/Carrying Case  
 LA-313 16-Unit Carrying Case  
 LA-320 Configurable Carrying Case

## Specifications

### RF Frequency Range:

72MHz: 72.05 - 75.95MHz  
 216MHz: 216.025 - 216.975 MHz

**Sensitivity:** .6uV typical, 1uV maximum for 12dB SINAD

### Signal to Noise Ratio\*:

80dB with SQ enabled (72 and 216MHz). 60dB (72MHz), 50dB (216MHz) with SQ disabled

**Frequency Response:** 50 to 15 KHz +/-3dB (10KHz at 216 MHz)

**Distortion:** < 2% THD

**Squelch:** On loss of RF signal

**Antenna:** Uses headphone cable

**Dimensions:** 3.0 in (7.6cm) wide by 1.0 in (2.5cm) deep by 5.0 in (13cm) height

**Weight:** 0.4 lb (0.18 kg) with batteries

**Belt Clip:** Built into back of unit

**Door:** Screwdriver lockable

**Headphone:** Many options available

**Power:** Two AA batteries, high capacity alkaline or NiMH rechargeable; external power connector 7.5 VDC, tip positive, <300mA

### Battery Life:

40 hours with high capacity alkaline, 20 hours with rechargeable NiMH

**Programmability:** Allows only programmed channels to be active

### Available Channels:

72MHz: 17 wide band, 40 narrow band  
 216MHz: 19 wide band, 38 narrow band

**Controls:** SEEK, Channel UP and DOWN available through the door; NiMH/Alkaline battery selection and SQ Disabling switches behind the door

\* **Wireless Transmission System Specifications:** End-to-end

## Architectural Specifications

The FM receiver shall be capable of receiving on 57 wide and narrow band channels. The receiver shall be programmable to electronically lock out unneeded channels. The receiver shall be capable of seeking channels. The receiver shall have an adjustable squelch. The receiver shall have an audio frequency response of 50Hz to 15KHz, +/- 3dB at 72MHz, or of 50Hz to 10kHz, +/- 3dB at 216MHz. The receiver will incorporate a stereo headset jack that allows the user to plug in either a mono or stereo headset. The receiver shall incorporate an LCD display that indicates channel, battery level, low battery, battery charging, and RF signal strength. The Listen LR-500 is specified.