

## LR-400 Display Receiver

**Model:** LR-400-072 (for 72MHz)  
LR-400-216 (for 216MHz)

**Specify Part Number**  
LR-400-072  
or LR-400-216

The Listen LR-400 Display Receiver offers 57 channels and is 100% digitally tuned. Listen's Look&Listen™ Display allows quick and easy verification of channel selection, RF signal strength, battery level and locking status. UP, DOWN, and SEEK buttons are placed behind the lockable door to discourage end user tampering. A multifunction LED display and built in belt clip complete the LR-400.



Lit LED = 'power on'  
Flashing = 'battery low'  
2X Flashing = 'charging'

Earphone plugs in here and can be securely fastened (accepts mono or stereo jacks)

Denotes 72 or 216MHz receiver

The LR-400's CHANNEL and SEEK features are behind lockable door



ON/OFF and volume control

Look & Listen™ Display – at-a-glance verification of channel selection, battery level, and RF signal strength

Mechanical lock prevents users from accessing UP, DOWN or SEEK controls, batteries or SQ disabling controls

### Key Features

- Exceptional audio quality! 80dB sound to noise ratio!\*
- 57 field tunable channels (unless you lock it on only one channel).
- Look&Listen™ Display shows channel selection, programming mode, RF signal strength, locking status and battery indicator.
- SEEK, UP and Down button selection controls are behind the mechanically locking door, thus discouraging end users from changing the channel selected..
- Excellent for general personal use, schools, language interpretation, museums, and tour group applications.
- 100 % Digital – Listen receivers are digitally-tuned so transmission won't drift; assurance that when you select a channel, it stays on channel!
- Built in SmartCharge™ won't allow batteries to overcharge! Charging circuitry is conveniently built into Listen's receivers; never worry about unplugging a transformer at a certain time.
- Press SEEK to find an in-range transmitting channel; perfect for personal use.
- Mechanical locking door to prevent tampering.

\* SNR when Listen SQ™ enabled from end-to-end on system

Listen and the Listen logo are registered trademarks of Listen Technologies Corporation, copyright 2002.

# LR-400 Display Receiver

Side View of LR-400 Display Receiver

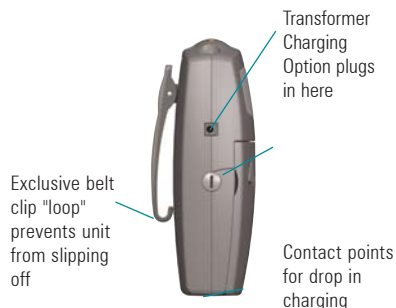

LR-400 Display Receiver with Lockable Door Open

Control buttons behind lockable door. To find a channel depress "seek", or to lock the channel, hold button down for 5 seconds (prevents users from changing channels)

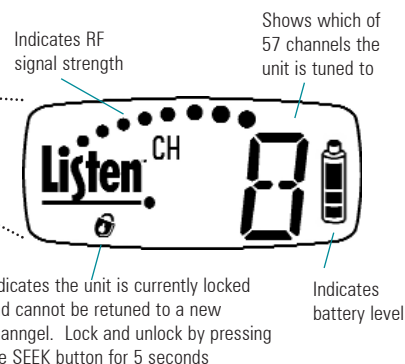

## Use With

- LA-161 Single Ear Bud
- LA-162 Dual Ear Buds
- LA-164 Ear Speaker
- LA-165 Stereo Headset
- LA-166 Neckloop
- LA-361 High Capacity Alkaline Batteries
- LA-362 NiMH Rechargeable Batteries
- LA-275 Sacrificial Cable

## Accessories

- LA-319 Protective Pouch
- LA-306 Soft Case
- LA-202 Power/Charging Supply for Listen Portable Units
- LA-317 4-Unit Charging/Carrying Case
- LA-318 4-Unit Carrying Case
- LA-323 8-Unit Charging/Carrying Case
- LA-322 8-Unit Carrying Case
- LA-311 16-Unit Charging/Carrying Case
- LA-313 16-Unit Carrying Case
- LA-320 Configurable Carrying Case

## Specifications

### RF Frequency Range:

72MHz: 72.05 - 75.95MHz  
216MHz: 216.025 - 216.975 MHz

**Sensitivity:** .6uV typical, 1uV maximum for 12dB SINAD

### Signal to Noise Ratio\*:

80dB with SQ enabled (72 and 216MHz). 60dB (72MHz), 50dB (216MHz) with SQ disabled

**Frequency Response:** 50 to 15 KHz +/-3dB (10KHz at 216 MHz)

**Distortion:** < 2% THD

**Squelch:** On loss of RF signal

**Antenna:** Uses headphone cable

**Dimensions:** 3.0 in (7.6cm) wide by 1.0 in (2.5cm) deep by 5.0 in (13cm) height

**Weight:** 0.4 lb (0.18 kg) with batteries

**Belt Clip:** Built into back of unit

**Door:** Screwdriver lockable

**Headphone:** Many options available

**Power:** Two AA batteries, high capacity alkaline or NiMH rechargeable; external power connector 7.5 VDC, tip positive, <300mA

### Battery Life:

40 hours with high capacity alkaline, 20 hours with rechargeable NiMH

### Available Channels:

72MHz: 17 wide band, 40 narrow band  
216MHz: 19 wide band, 38 narrow band

**Controls:** SEEK, Channel UP and DOWN behind lockable door; NiMH/Alkaline battery selection and SQ Disabling switches behind the door

\* **Wireless Transmission System Specifications:** End-to-end

## Architectural Specifications

The FM receiver shall be capable of receiving on 57 wide and narrow band channels. The receiver shall be capable of seeking channels. The receiver shall have an adjustable squelch. The receiver shall have an audio frequency response of 50Hz to 15KHz, +/- 3dB at 72MHz, or of 50Hz to 10kHz, +/- 3dB at 216MHz. The receiver will incorporate a stereo headset jack that allows the user to plug in either a mono or stereo headset and listen to the audio normally. The receiver shall incorporate an LCD display that indicates channel, battery level, low battery, battery charging, RF signal strength. The Listen LR-400 is specified.